

117-001 thru 117-006, 2165,
2-165, 165, 3Z836, 3Z836A, 160A

117-001 THRU 117-006
(LAYOUT MAY VARY)

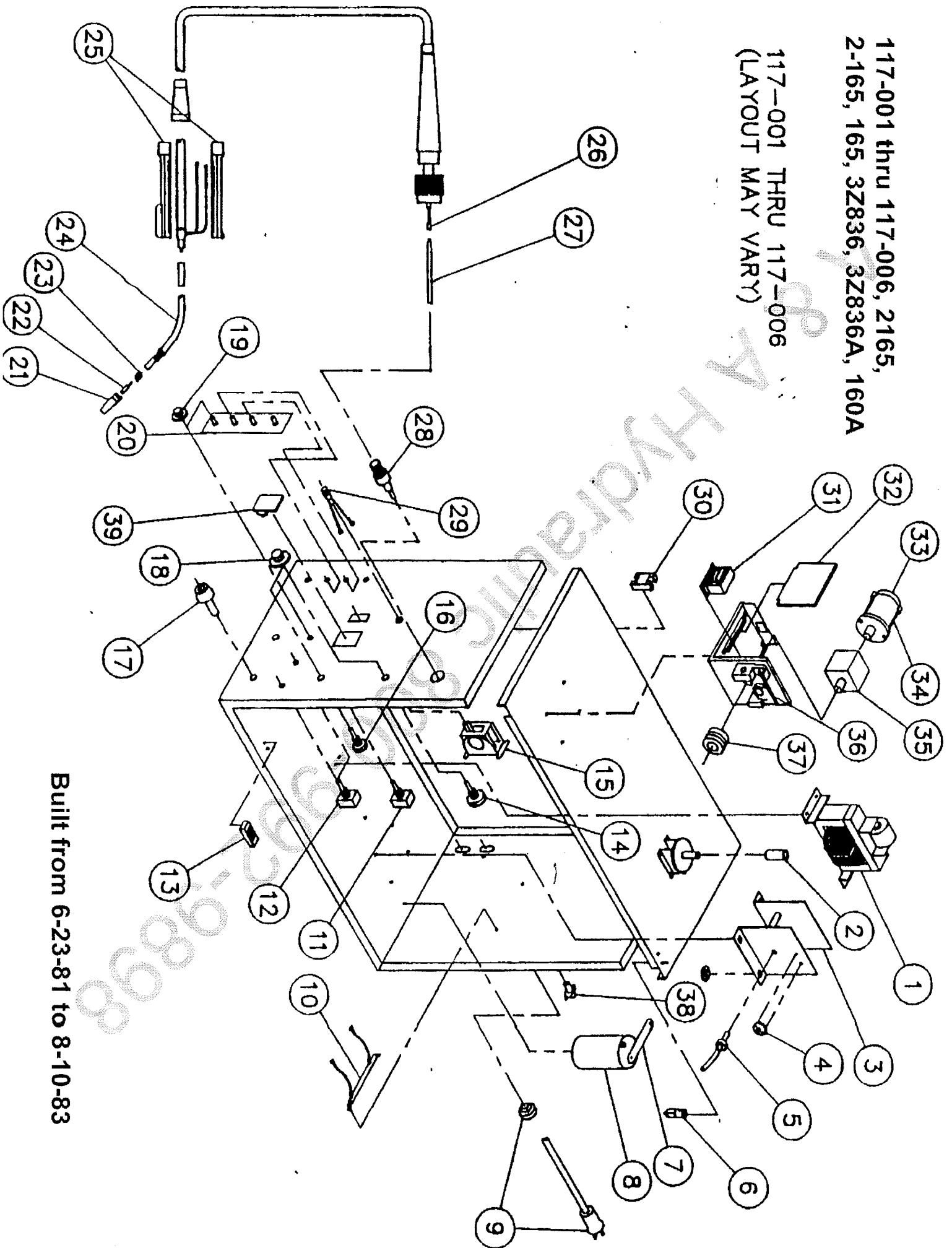

Built from 6-23-81 to 8-10-83

117-001 thru 117-006, 2165, 2-165, 165, All Star, Henning Hansen 160a

Item	Lincoln #	Customer #	Description
1		860-507-888	Weld Transformer
2	312-110-666	312-087-666	Spindle adapter
3		860-506-666	Heat sink Assy.
4	216-053-666	216-053-000	Thermostat
5	214-004-666	214-004-666	Diode
6	246-086-666	246-086-666	Gas solenoid
7		410-190-666	Buss bar
8	213-018-666	213-018-666	Capacitor
9		248-164-666	Powercord
10		860-523-000	Resistor assy., 25Ω, 50 watt
11		216-051-666	Toggle switch, burrback
12		216-057-666	Toggle for 117-003, 004 only
13		216-058-666	Momentary switch, purge & inch
14		239-094-666	Terminal block
15	216-042-666	246-052-666	Heat switch (9 position)
16		216-042-666	Power switch
17	312-045-666	246-093-000	Wire speed potentiometer
18		312-045-666	Receptacle assembly
19		246-095-000	Knob
20	860-489-666	246-094-000	Knob
21	860-489-666	860-489-666	Spot/Stitch circuit board
22	334-164-400	4306, M15520	Nozzle, tapered for steel
	KP2039-1B1	43090	0.025 Contact tips
	KP2039-2B1	43100	0.030 Contact tips
	KP2039-3B1	43110	0.035 Contact tips
23	334-172-000	4318	Nozzle spring

Model	Primary Input	Input Plug	Duty Cycle at Rated Output
117-003	230V, 20A	25A	20%

Item	Lincoln #	Customer #	Description
24	334-174-666	334-174-666	Gooseneck
25		334-178-666	Handle assembly
26	411-121-666	4315	Steel liner
	411-123-666	4317	Teflon liner
27		410-248-666	Guide tube for steel liner
28		860-494-666	Gun connector
29		245-078-666	Indicator light
30	216-055-666	216-055-666	Triac relay
31		860-503-888	Control Transformer, 230Vac - 24Vac
32	860-504-666	860-504-666	Main circuit board
33		216-049-001	Drive motor end cap
34		216-049-666	Drive motor
35		216-050-666	Gear box
36		860-528-666	Tensioner
37		860-571-500 (4326)	Drive wheel for 117-002 - 117-006
		4321	Orange Roller (NLA)
38		246-116-000	Fuse holder
		245-060-000	Fuse only (BAN30 or BLN30)
39		247-063-666	Wire speed meter
Not Shown			
40		860-492-666	Wiring inside drive box
41		410-347-020	Right side panel
		410-348-020	Left side panel
42		410-230-100	Hood
43	334-644-000	238-123-000	Complete Gun Assembly

Rated Output	Voltage Settings	Agency Listing	Max Output
100 amps	9	None	130 amps

5/9/2006

334-303-001 Regulator
059-245-666 Gas Hose

Built from 6-23-81 to 8-10-83