

117-022, YA219

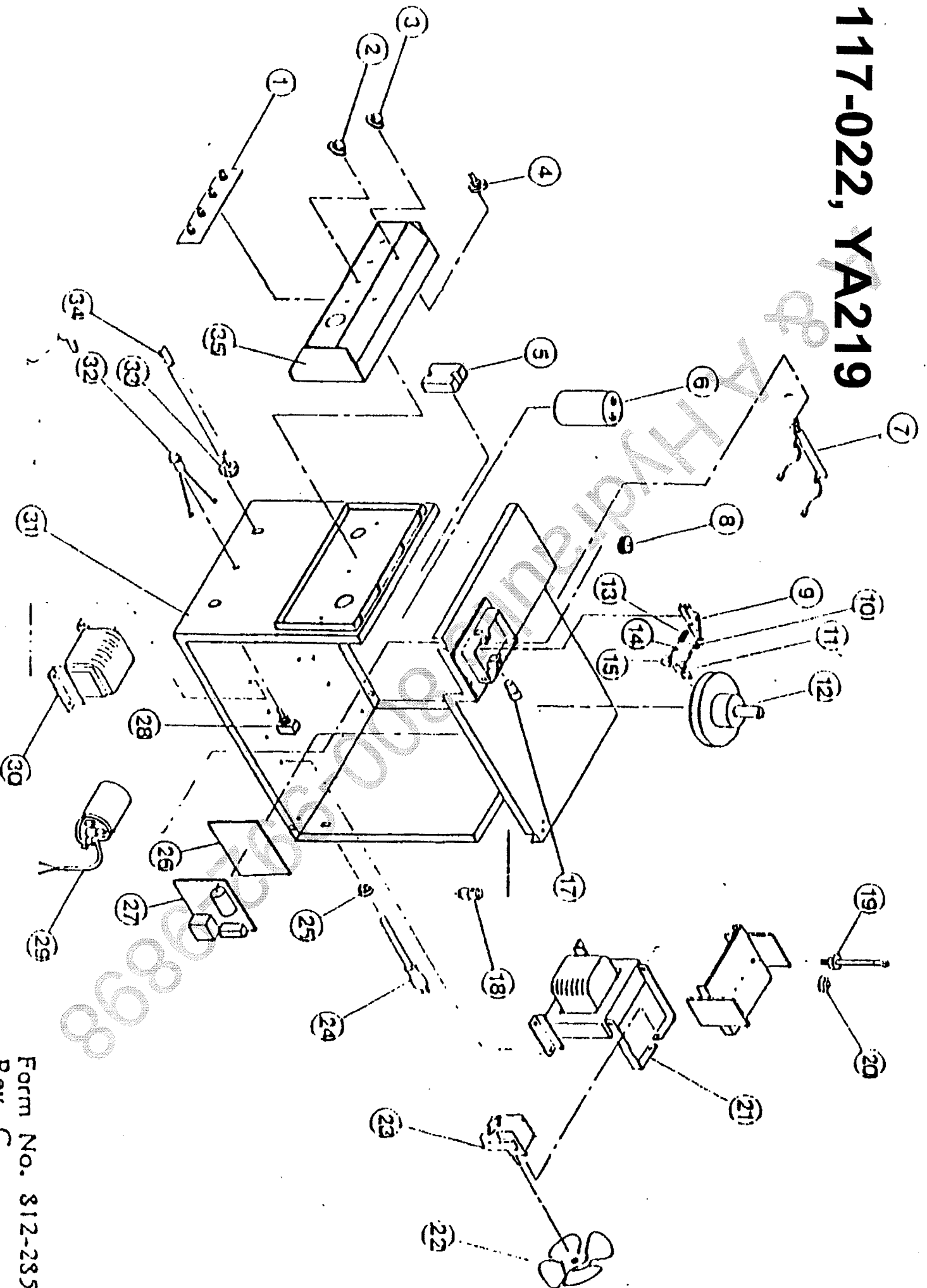

117-022, YA219

Item	Lincoln Stock #	Customer #	Description
1	860-489-666	860-489-666	Spot Switch PCB
2		246-127-666	Knob, 1 3/16"
3		246-162-666	Knob, 1 3/16"
4		246-104-000, 246-052-000	5 Position Heat Switch
5	216-055-666	216-055-666	Triac Relay, 40 amp
6	213-018-666	213-018-200	Capacitor, 45,000mf, 45Vdc
7		860-523-000	Resistor assy., 25Ω, 50 watt
8	310-122-500	4323	Drive roller, 0.024 / 0.030 / 0.035
	860-616-002	4324	Drive roller, teflon
9		310-123-000	Tension bar w/bearing
10		091-040-000	Flatwasher
11		246-114-000	Stud w/groove
12	312-066-666	312-066-666	Spindle
13		330-025-000	Spring
14		310-144-000	Bearing washer
15		246-160-000	Tension knob
17		410-325-000	Inlet guide tube
18	246-086-666	246-086-666	Gas solenoid, 18-24Vdc
19	860-476-666	860-476-666	Diode assy.
20	216-053-666	216-053-000	Thermostat

Model	Primary Input	Input Plug	Duty Cycle at Rated Output
117-022	120V, 15A	15A	20%

Item	Lincoln Stock #	Customer #	Description
21		860-809-888	Main weld transformer
22		316-009-100	Fan blade (draws air in on this model)
23	216-087-666	216-070-000	Fan motor
24		248-182-000	Power cord
25		541-020-000	Strain relief
26		512-041-000	Insulation
27	860-614-666	860-614-666	Main circuit board
28		216-044-100	Power switch
29	216-079-666	860-581-100	Drive motor, 24Vdc
30		860-572-888	Reactor coil
31		711-155-020	Faceplate
32		245-085-000	Indicator light, 120V
33		541-057-000	Strain relief
34		238-116-000	Ground Cable, 9', 6ga, .265 lug
35		312-062-000	Nose
Not Shown			
34	238-155-000	4320	Mig gun assembly, 10'
35	334-303-001	334-286-666	Gas regulator
36	059-245-666		Gas hose
37		860-808-888, 880-070-888	Control T transformer

Rated Output	Voltage Settings	Agency Listing	Max Output
90 amps	5	None	90 amps