

REPLACEMENT PARTS LIST

117-028

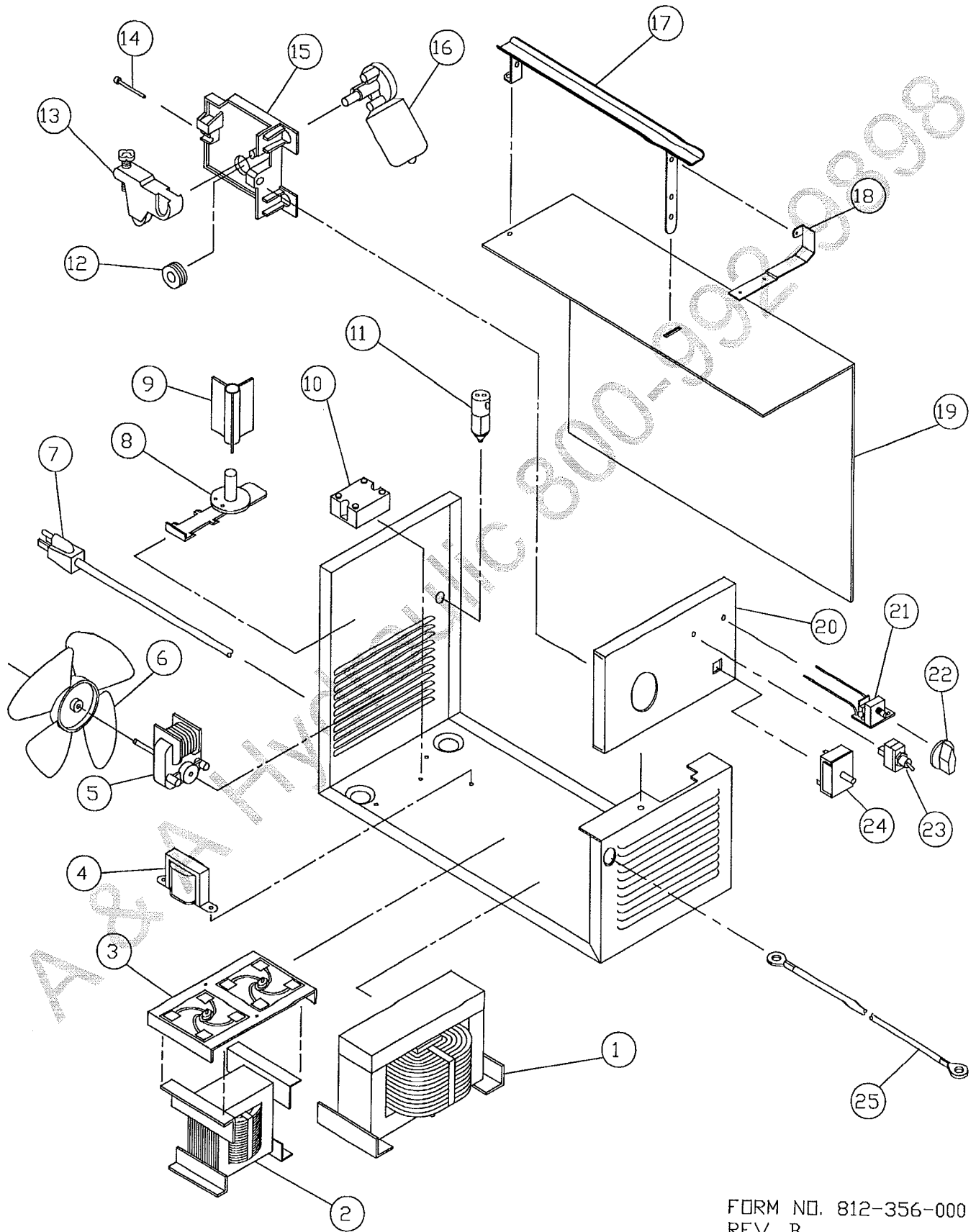

117-028 Century 75 Amp Wirefeed Welder

Item	Lincoln Stock #	Customer #	Description
1		860-904-888	Main weld transformer
2		860-903-888	Reactor Coil w/ thermostat
		246-169-000	Thermostat only
		(Klixon 7AM028A10)	
3		860-905-666	Rectifier assy.
4		860-902-888	Control Transformer (120Vac - 24Vac)
5		216-087-666	Fan motor
6		316-009-000	Fan blade
7		248-185-666	Power cord
8		312-076-666	Wire spindle
9		312-110-666	Spool adapter
10		216-055-666	Trac relay
11		246-086-666	Gas solenoid
12		310-122-500	Drive roller, 0.024 / 0.030 / 0.035
13		880-089-666	Tension arm only
		312-107-000	
14		239-123-666	Inlet guide tube
		239-208-000	
15		312-103-666	Drive base only
		312-144-000	
16		216-079-666	Drive Motor w/gearbox
17		880-012-010	Handle
18		412-278-010	Hood hinge
19		410-568-020	Right side panel
20		410-505-020	Front panel
21		880-094-666	Wire speed control assy
22		246-041-666	Knob

Model	Primary Input	Input Plug	Duty Cycle at Rated Output
117-028	120V, 15 amp	15A	20%

Item	Lincoln Stock #	Customer #	Description
23		246-178-000	Rocker switch
24		246-057-666	Rate switch
25		238-223-666	Ground cable

Not Shown			
Item	Lincoln Stock #	Customer #	Description
26	238-155-000	4320	10' Mig Gun less tip and nozzle
27	KP1937-1	4331	Steel liner
28	KP1959-1	4325	Teflon liner
29		410-557-010	Left side panel
30		410-569-020	Hood
31		218-942-666	Polarity Jumper
32		412-280-666	Gun Connector
33	334-203-000	43480	Steel welding nozzle
34	334-210-300	43300	Aluminum welding nozzle
35	334-211-300	43290	Spot welding nozzle
36	334-159-300	43090	0.024 Contact Tips (6)
37	334-160-300	43100	0.030 Contact Tips (6)
38	334-228-000	334-228-000	Gas diffuser
39		334-217-000	Insulation
40		334-219-000	Handle Cap
41		084-019-000	Set Screw, #8-32 X 1/8"
42	334-221-000		Trigger
42		860-744-000	Trigger harness
43	Standard Hardware Item		6-32 X 7/16" screw for trigger

Rated Output	Voltage Settings	Agency Listing	Max Output
75 amps	4	UL	75 amps, gas only