

117-035, 2225

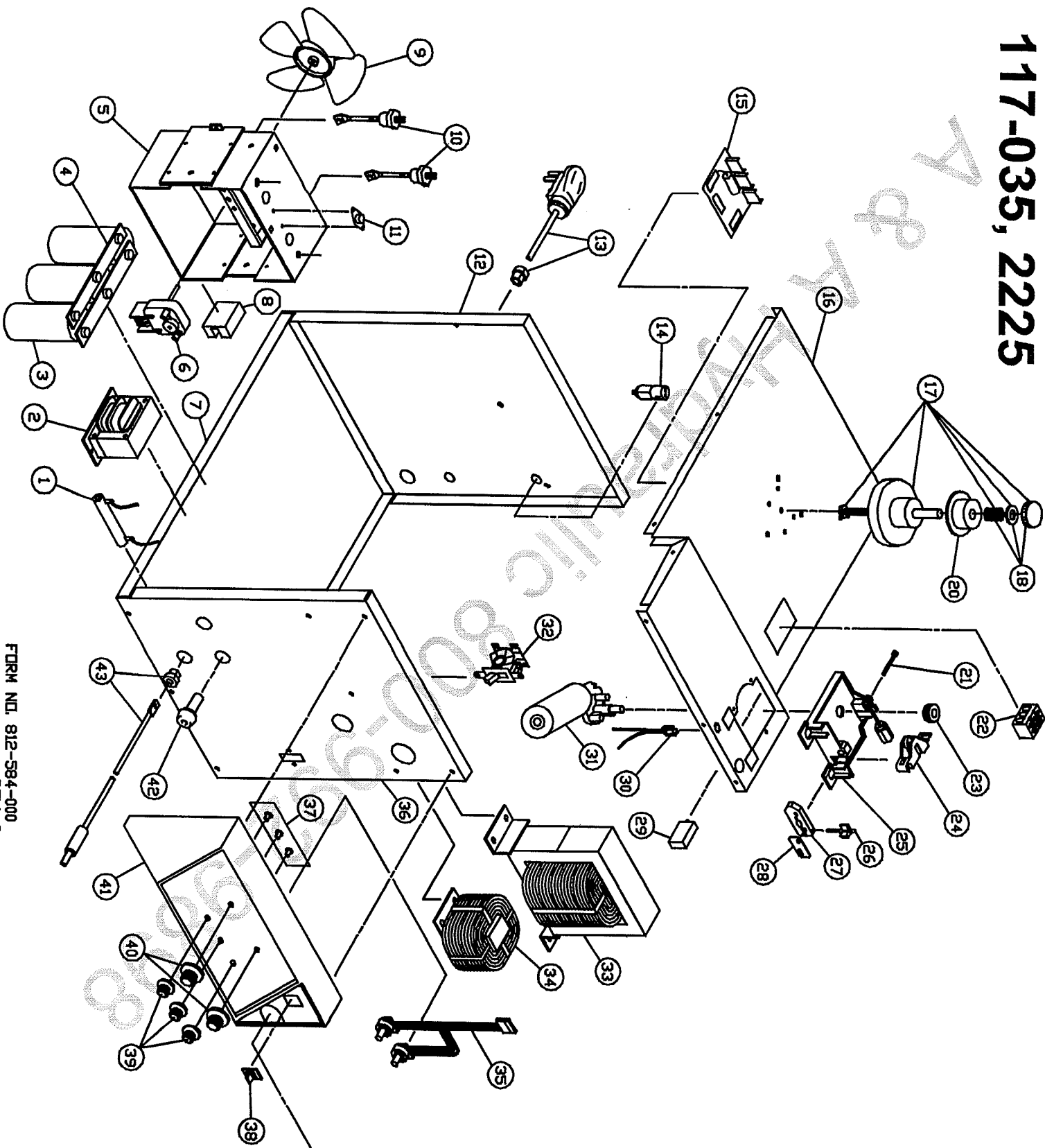

117-035, Solar 2225, 225 Amp Mig

Item	Lincoln Stock #	Customer #	Description
1		880-158-666	Bleeder Resistor
2		880-041-888	Control Transformer, 230Vac to 24Vdc, 6 amp
3	213-018-666	213-018-666	Capacitor, 45,000mf, 45Vdc
4		412-202-000	Buss bar
5		860-039-000	Fan shroud/heat sink assy.
6	216-099-666	216-085-666	Fan motor
7		410-594-000	Base
8	216-062-666	216-062-000	Triac Relay, 75 amp
9		316-010-000	Fan blade
10	244-070-666	244-070-666	Diode
11		216-053-000	Thermostat
12		410-675-010	Back panel
13		248-178-666, 248-289-000	Power Cord, 8/3, 8.5' w #10 Spade(2) & #10 Ring Term.
14	246-086-666	246-086-666	Gas solenoid, 24Vdc
15	880-113-666	880-292-008	Main Circuit Board
16		410-593-010	Drive deck
17	312-066-666	860-575-100	Spindle/Tension kit
18	312-066-666	246-363-000	Tensioner kit - Order #17
20	312-110-666	541-083-000	Spindle adapter
21		239-208-000	Inlet guide tube
22		239-057-000	Terminal block
23	310-122-500	4323	Drive roller, 0.024 / 0.030 / 0.035
24		310-154-000	Drive roller 0.045 serrated
25	880-130-666	880-111-666	Tension arm only
26		880-130-666	Drive base assembly with arm
27	412-465-666	246-326-000	Gun connector knob
28		412-464-000	Gun connector block
29		246-365-000, 246-142-666	Copper jumper
30		880-035-666	Circuit breaker for drive motor
31	216-089-666	216-089-666	Gun wiring harness (female)
32	216-010-666	216-010-666	Drive Motor w/gearbox
33		880-040-888	Power switch
34		860-772-888	Main Transformer
35	880-052-666	880-043-666	Reactor
Model	Primary Input	Input Plug	Duty Cycle at Rated Output
117-035	208/230V, 44A/40A	50A	60%

Item	Lincoln Stock #	Customer #	Description
36		410-593-030	Front panel
37	880-114-666	880-114-666	Spot/Stitch circuit board assy.
38		216-077-666	Paddle switch
39		246-139-666	Knob
40		246-095-000	Knob
41		312-110-666	Molded nose
42	312-045-666	312-045-666	Receptacle
43		238-193-000	Jumper cable
52		084-019-000	Set screw #8-32 x 1/8"
53		860-744-000	Gun wire harness
Not Shown			
54	238-393-000	238-393-000	Complete gun assy 12'
55	238-296-666	238-296-666	Complete gun assy 15'
56	334-252-000	334-254-000	Gun handle case (90206)
57		334-252-000	Conductor tube
58	334-302-000	334-302-000	Handle cap (250-86c)
59	334-375-000,	432, 843, 480	Steel nozzle
	4370	4329, 43290	Spot nozzle
	4310	4330, 43300	Aluminum nozzle
	4311	4309	0.024 contact tip
	4311	4310	0.030 contact tip
	4339	4311	0.035 contact tip
60	334-363-000	4339	0.045 contact tip
61	334-255-000	334-363-000	Gas diffuser
62	334-375-000,	334-255-000	Trigger 96KL-R
	4370	334-375-000,	Steel liner
	4368	334-376-000,	Teflon liner
63	334-303-001	334-303-001	Gas Regulator
64	059-245-666	059-245-666	Gas Hose
65	310-122-500	4323	Steel drive roller
66	860-616-002	860-616-002	Composite drive roller for Alum.
67	246-103-000	246-103-000	Hood handle
68	238-009-500	238-009-500	Ground cable assy w/clamp 12'
69	239-292-666		Ground clamp only

Rated Output	Voltage Settings	Agency Listing	Max Output
225 amps	Infinite	CSA	250 amps