

117-037, 83160, M02195, 3Z914A,C,D,E

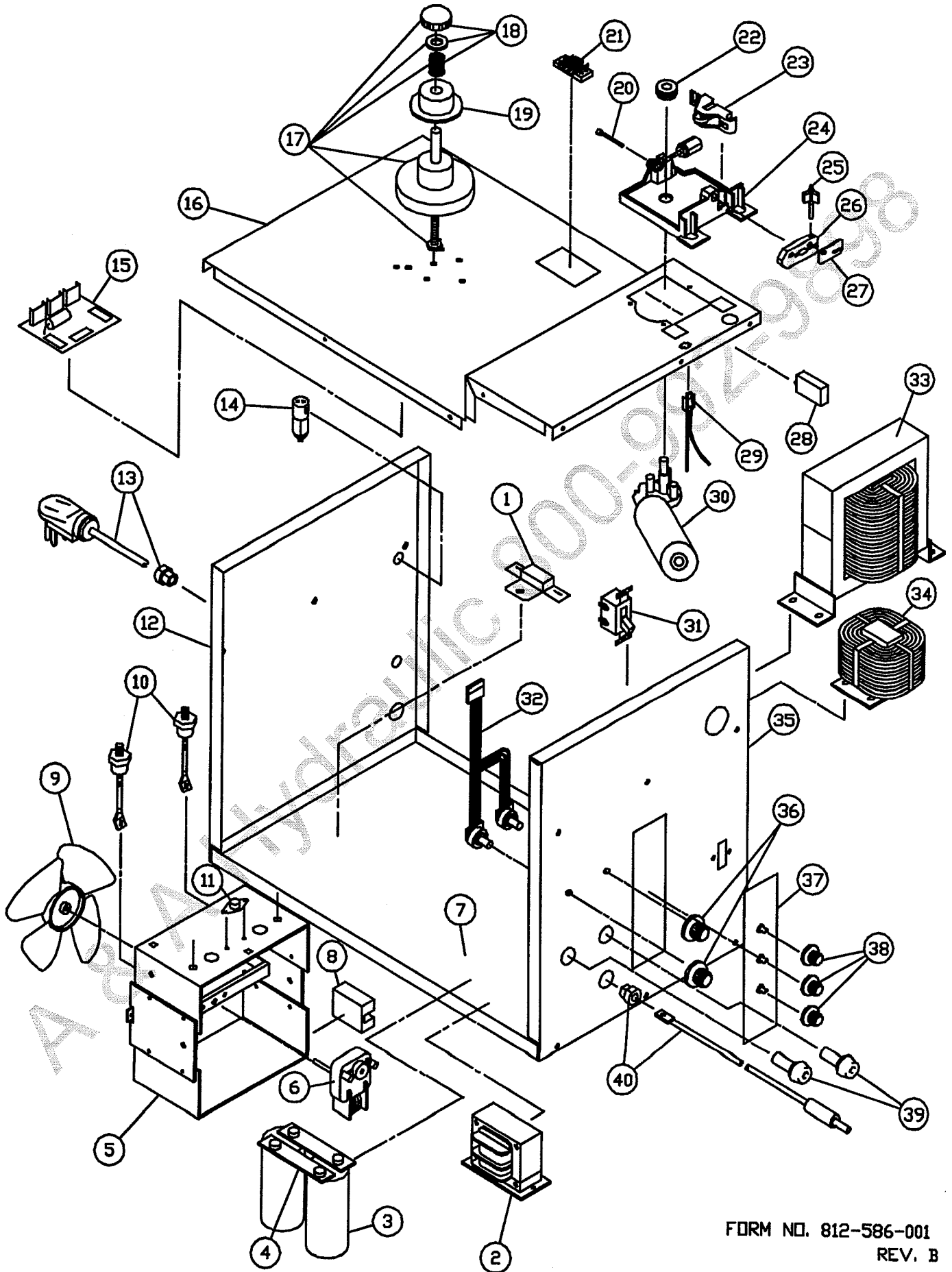

117-037, 83160, M02195, 3Z914A, C, D 160 Amp Mig

Item	Lincoln Stock #	Customer #	Description
1		245-145-000, 245-038-200	25Ω, 50 Watt bleeder resistor
2	880-041-888	880-041-888	Control Transformer, 230Vac to 24Vdc, 6 amp
3	213-018-666	213-018-666	Capacitor, 45,000mf, 45Vdc
4		412-202-000	Buss bar
5		860-039-000	Fan shroud/heat sink assy.
6	216-099-666	216-085-666	Fan motor
7		410-594-000	Base
8	216-062-666	216-062-000	Triac Relay, 75 amp
9		316-010-000	Fan blade
10	214-004-666	214-004-666	Diode
11		216-053-000	Thermostat
12		410-675-020	Back panel
13	248-301-000, 248-377-666	248-165-666	Power cord, 10/3, 6'
14	246-086-666	246-086-666	Gas solenoid, 24Vdc
15	880-113-666	880-292-008	Main Circuit Board
16		410-674-010	Drive deck
17	312-066-666	860-575-100	Spindle
18		246-363-000	Tensioner knob only (no spring or washer)
19	312-110-666	541-083-000	Spindle adapter
20		239-208-000	Inlet guide tube
21		239-102-666	Terminal block
22	310-122-500	4323	Drive roller, 0.024 / 0.030 / 0.035
23		310-154-000	Drive roller 0.045 serrated
24	880-130-666	312-107-000	Tension arm only
25		312-144-000	Drive base assembly
26		246-326-000	Gun connector knob
27	412-465-666	412-465-666	Gun connector block
28		412-464-000	Copper jumper
29		246-365-000, 246-142-666	Circuit breaker for drive motor
30	216-089-666	860-035-666	Gun wiring harness (female)
31	246-371-000	216-089-666	Drive Motor w/gearbox
32	216-042-666	216-042-666	Power switch (closed box for 117-037's (open contacts))
	880-052-666	880-052-666	Heat & wire speed harness w/ potentiometers

Item	Lincoln Stock #	Customer #	Description
33	880-057-888	880-249-888	Main weld transformer
34		860-670-888	Reactor coil
35		410-806-060	Front panel
36		246-095-000	Knob, 1.5"
37	880-114-666	880-114-666	Spot-Stitch circuit board
38		246-094-000	Knob, 1"
39	312-045-666	312-046-666	Receptace, panel mount
40		238-160-666	Polarity jumper
Not Shown			
41		860-744-000	Gun wiring harness (male)
42	238-393-000	4365	Mig gun assembly, 12'
43	238-296-666		Mig gun assembly, 15'
44		084-019-000	Allen set screw #8-32 X 1/8"
45		334-254-000 (90206)	Handle Case
46	334-252-000		Conductor Tube
47		334-302-000 (90035)	Handle Cap
48	334-203-300	43480	Standard Nozzle
49	334-211-300	43290, M15577	Spot Nozzle, Notched
50	334-159-300	43090	0.024 Contact Tips (6)
51	334-160-300	43100	0.030 Contact Tips (6)
52	334-161-300	43110	0.035 Contact Tips (6)
53	334-202-300	43390	0.045 Contact Tips (6)
54	334-363-000		Gas Diffuser
55	334-255-000		Trigger
56	KP1933-1	334-375-000, 4370	Steel Liner
57	KP1955-1	334-376-000, 4368	Teflon Liner
58	238-009-500	4009	12' #3 Ground cable w/plug
59	239-010-301	41001	Ground clamp only
60		246-103-000	Hood handle
61		410-391-010	Right side panel
62		410-392-010	Left side panel
63		410-390-010	Hood
64	334-286-666		Gas Regulator
65	059-245-666		Gas Hose

Model	Primary Input	Input Plug	Duty Cycle at Rated Output
117-037	208/230V, 30a	50A	60%

Rated Output	Voltage Settings	Agency Listing	Max Output
160 amps	Infinite	CSA	200 amps

8/11/2005