

117-040, YA219B

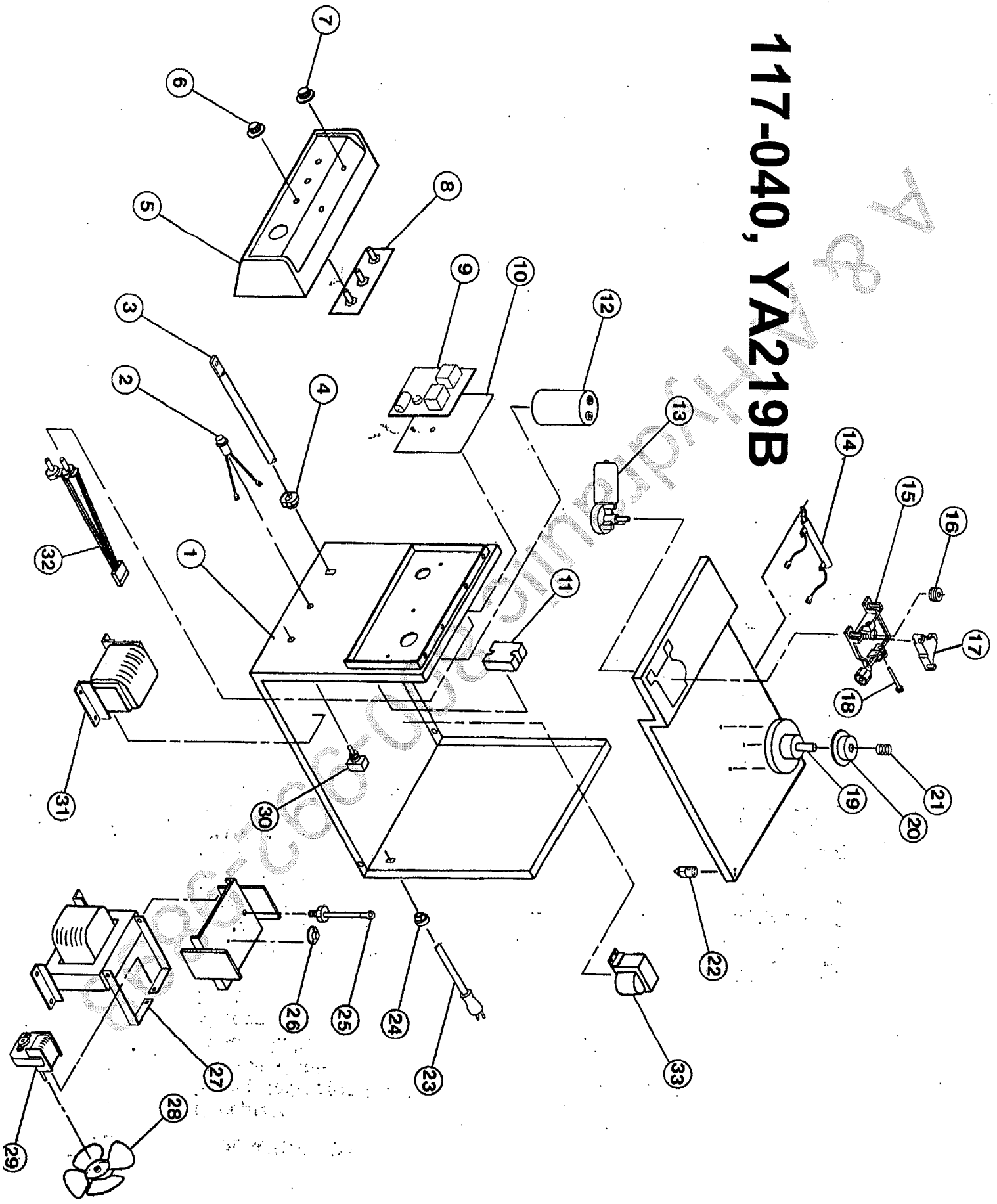

117-040, YA219B

Item	Lincoln Stock #	Customer #	Description
1		711-155-056	Faceplate
2		245-085-666	Power Light, 120 Vac
3		238-116-666	Ground Cable, 6 ga., 9'
4		541-057-000	Strain Relief
5		312-102-666	Molded Nose
6		246-127-666	Knob
7		246-162-666	Knob
8	880-114-666	880-114-666	Spot-Stitch circuit board
9	880-113-666	880-113-666	Main Circuit Board
10		512-041-666	Insulation
11	216-055-666	216-055-666	Triac Relay, 40 amp
12	213-018-666	213-018-666	Capacitor, 45,000mf, 45Vdc
13	216-079-666	216-079-666	Drive Motor w/gearbox, OSLV
14		245-038-200	25Ω, 50 Watt bleeder resistor
15	880-130-666	880-130-666	Drive base assembly
16	310-122-500	4323	Drive roller, 0.024 / 0.030 / 0.035
17		312-107-000	Tension arm only
18		239-208-000	Inlet guide tube
19	312-066-666	860-575-100	Spindle
20	312-110-666	312-110-666	Spool Adapter
21		330-029-666	Spool Tensioner Spring
22	246-086-666	246-086-666	Gas solenoid, 24Vdc
23		248-182-666	Power Cord
24		541-020-666	Strain Relief
25	860-476-666	860-476-666	Diode assy.
26	216-053-666	216-053-666	Thermostat
27		880-071-888	Main Transformer
28		316-009-666	Fan Blade
29	216-087-666	216-087-666	Fan Motor
30		246-210-666	Power Switch, SPST, 20A, 120Vac
31		860-572-888	Reactor
32	880-052-666	880-052-666	Heat & wire speed harness w/ potentiometers
33		880-070-888	Drive Transformer

Not Shown

34	238-155-000	235-155-500	10' Mig Gun	334-303-001 Gas regulator
35		412-304-666	Copper jumper bar	059-245-666 Gas Hose
36		412-280-666	Gun Connector	860-616-002 Composite Drive Roller

Model	Primary Input	Input Plug	Duty Cycle at Rated Output
117-040	120V, 15A	15A	20%

8/8/2006

Rated Output	Voltage Settings	Agency Listing	Max Output
90 amps	Infinite	CSA	90 amps