

A & A Hydraulic Repair Co.
5301 West 161st. Street
Cleveland, OH 44142
Phone 800-992-9898 Fax 216-362-4020
Web Page: www.hydraulicparts.com

REPLACEMENT PARTS LIST CENTURY 250 WIRE FEED WELDER MODEL 117-042 CSA

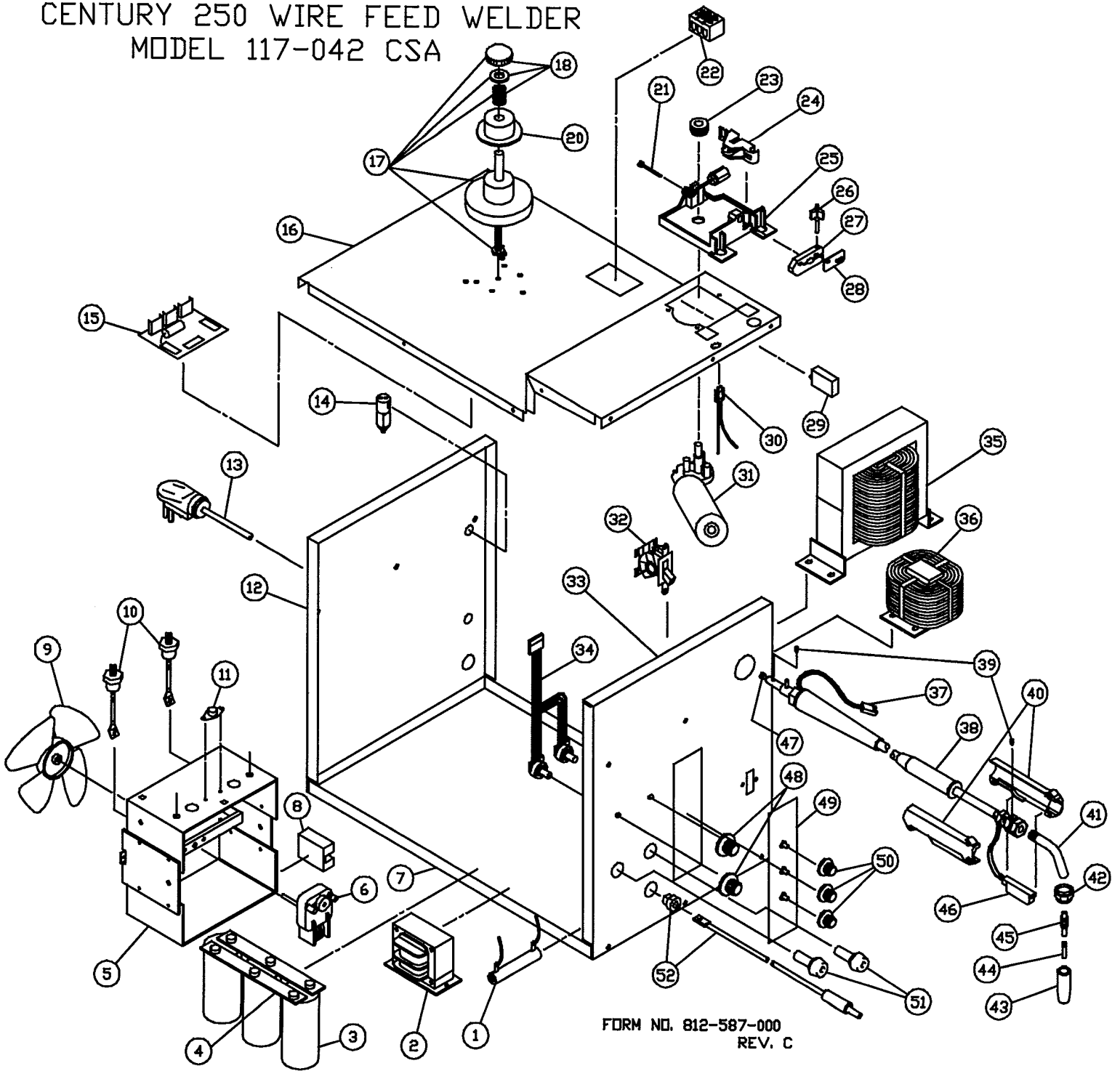

FORM NO. 812-587-000
REV. C

117-042, 83225, 5Z136, 5Z136A, 5Z136B, M02225, WF225a, WS225K

117-042, 83225, 5Z136, 5Z136A, 5Z136B, M02225, WF225, WS225K, 225 Amp Mig

Item	Lincoln Stock #	Customer #	Description
1		880-158-666	Bleeder Resistor
2		880-041-888	Control Transformer, 230Vac to 24Vdc, 6 amp
3		213-018-666	Capacitor, 45,000mf, 45Vdc
4		412-202-000	Buss bar
5		860-039-000	Fan shroud/heat sink assy.
6		216-099-666	Fan motor
7		410-594-000	Base
8		216-062-000	Triac Relay, 75 amp
9		316-010-000	Fan blade
10		244-070-666	Diode
11		216-053-000	Thermostat
12		410-675-020	Back panel
13		248-178-666, 248-289-000	Power Cord, 8/3, 8.5' w #10 Spade(2) & #10 Ring Term.
14		246-086-666	Gas solenoid, 24Vdc
15		880-113-666	Main Circuit Board
16		410-674-010	Drive deck
17		312-066-666	Spindle/tension kit
18		312-066-666	Tensioner assy. (see #17)
20		312-110-666	Spindle adapter
21		239-208-000	Inlet guide tube
22		239-057-000	Terminal block
23		310-122-600	Drive roller, 0.024 / 0.030 / 0.035
		4323	Drive roller 0.045 serrated
		310-154-000	Aluminium drive roller
24		860-616-002	Tension arm only
25		880-130-666	Drive base assembly with arm
26		246-326-000	Gun connector knob
27		412-465-666	Gun connector block
28		412-464-000	Copper jumper
29		246-365-000 , 246-142-666	Circuit breaker for drive motor
30		880-035-666	Gun wiring harness (female)
31		880-035-666	Drive Motor w/gearbox
32		216-010-666	Power switch
33		410-805-080	Front panel
Model	Primary Input	Input Plug	Duty Cycle at Rated Output
117-042	208/230V, 44A/40A	50A	60%

Item	Lincoln Stock #	Customer #	Description
34		880-052-666	Heat & wire speed harness w/ potentiometers
35		880-040-008	Main weld transformer
36		860-772-888	Reactor coil
37		860-744-000	Gun wiring harness (male)
38		238-393-000	Mig gun assembly, 12'
		238-296-666	Mig gun assembly, 15'
39		084-019-000	Set Screw, #8-32 X 1/8"
40		334-254-000	Handle Case (90206)
41		335-252-000	Conductor Tube
42		334-302-000	Handle Cap (250-86C)
43		KP21T-50	Standard Nozzle (KP1942-2)
		KP21-62FAS	Spot Nozzle, Notched (KP1956-1)
44		KP11-25	0.025 Contact Tips (KP2039-1)
		KP11-30	0.030 Contact Tips (KP2039-2)
		KP11-35	0.035 Contact Tips (KP2039-3)
45		334-363-000	0.045 Contact Tips (KP2039-4)
46		334-255-000	Gas Diffuser
47		334-375-000, 4370, KP1933-1	Trigger
		334-376-000, 4368, KP1955-1	Steel Liner
48		246-095-000	Teflon Liner
49		880-114-666	Knob, 1.5"
50		246-094-000	Spot-Stitch circuit board
51		312-045-666	Knob, 1"
52		238-193-000	Receptacle, panel mount Jumper assy.
Not Shown			
53		238-009-500	Ground cable w/plug & clamp, 12'
54		239-292-666	Ground clamp
55		KP21T-62	Aluminium nozzle (KP1942-3)
56		410-390-010	Hood
57		246-103-000	Hood handle
58		334-303-001	Regulator
59		059-245-666	Gas hose
60		332-337-300	Welding helmet
Rated Output	Voltage Settings	Agency Listing	Max Output
225 amps	Infinite	CSA	250 amps