

# REPLACEMENT PARTS LIST CENTURY 130 WIRE FEED WELDER MODEL 117-052, 83105

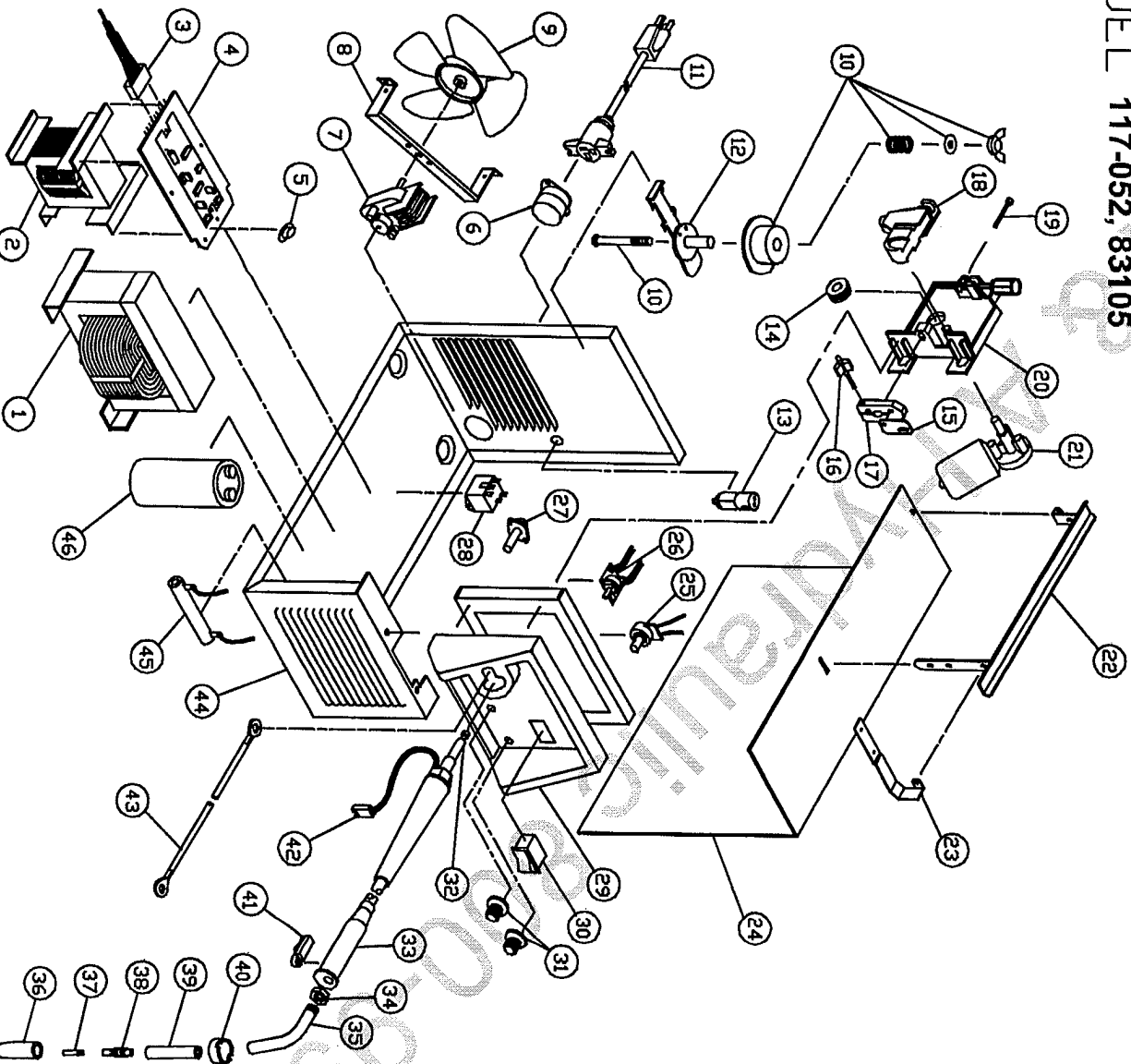

ITEM	PART NO.	DESCRIPTION
1	880-188-888	TRANSFORMER ASSEMBLY
2	880-215-888	REACTOR ASSEMBLY
3	880-225-666	WIRE HARNESS
4	880-217-666	HEATSINK/PCB ASSEMBLY
5	216-053-666	THERMAL PROTECTOR
6	239-159-666	POWER RECEPTACLE
7	216-087-666	FAN MOTOR
8	412-375-000	FAN MOTOR BRACKET
9	316-009-666	FAN BLADE
10	131-350-001	TENSION KIT
11	518475	POWER CORD
12	312-076-666	WIRE SPINDLE
13	246-212-666	SOLENOID SWITCH
14	4347	DRIVE ROLLER .045 SERRATED
15	410-464-666	DRIVE ROLLER .024/.030/.035
16	246-326-000	MIG CONNECTOR JUMPER
17	412-465-666	MIG GUN CONNECTOR
18	880-111-666	DRIVE TENSIONER ASSEMBLY
19	239-123-666	INLET GUIDE TUBE
20	880-130-666	DRIVE BASE ASSEMBLY
21	216-089-666	DRIVE MOTOR
22	880-012-010	HANDLE ASSEMBLY
23	412-278-016	HOOD HINGE
24	410-568-020	RIGHT SIDE PANEL
25	245-108-666	HEAT POTENTIOMETER
26	880-219-666	WIRE SPEED PCB
27	246-116-666	FUSE HOLDER
28	245-060-666	FUSE DONLY
29	246-258-666	RELAY
30	743-267-666	MIG NOISE W/LABEL
31	246-259-666	ROCKER SWITCH
32	246-107-666	KNDS
33	4331	STEEL LINER
34	238-155-100	TEFLON LINER
35	334-220-000	GUN ASSEMBLY
36	334-227-000	GUN ASSEMBLY
37	4330	CONDUCTOR TUBE
38	4329	NOZZLE, STEEL (TAPERED)
39	4309	NOZZLE, FLUX OR ALUM. (STRAIGHT)
40	4310	NOZZLE, SPOT (NOTCHED)
41	0024	CONTACT TIPS (BAG OF 6)
42	0035	CONTACT TIPS (BAG OF 6)
43	0045	CONTACT TIPS (BAG OF 6)
44	4339	GAS DIFFUSER
45	334-228-000	CONDUCTOR TUBE INSULATION
46	334-217-000	HANDLE CAP
47	334-219-000	TRIGGER
48	334-221-000	GUN WIRING HARNESS
49	860-744-000	GROUND CABLE ASSEMBLY
50	238-155-100	MIG BASE
51	334-285-666	BLEEDER RESISTOR ASSEMBLY
52	410-575-030	CAPACITOR
53	412-406-010	TANK CHAIN (NOT SHOWN)
54	412-271-010	TANK BRACKET (NOT SHOWN)
55	412-251-010	TANK TRAY STRAPS (NOT SHOWN)
56	412-249-000	TANK CHAIN (NOT SHOWN)

FORM NO. 812-504-000  
REV. D

860-616-002  
Composite Drive Roller