

REPLACEMENT PARTS LIST
 SOLAR 105 AMP WIRE FEED WELDER
 MODEL 117-053, 2140, 20549

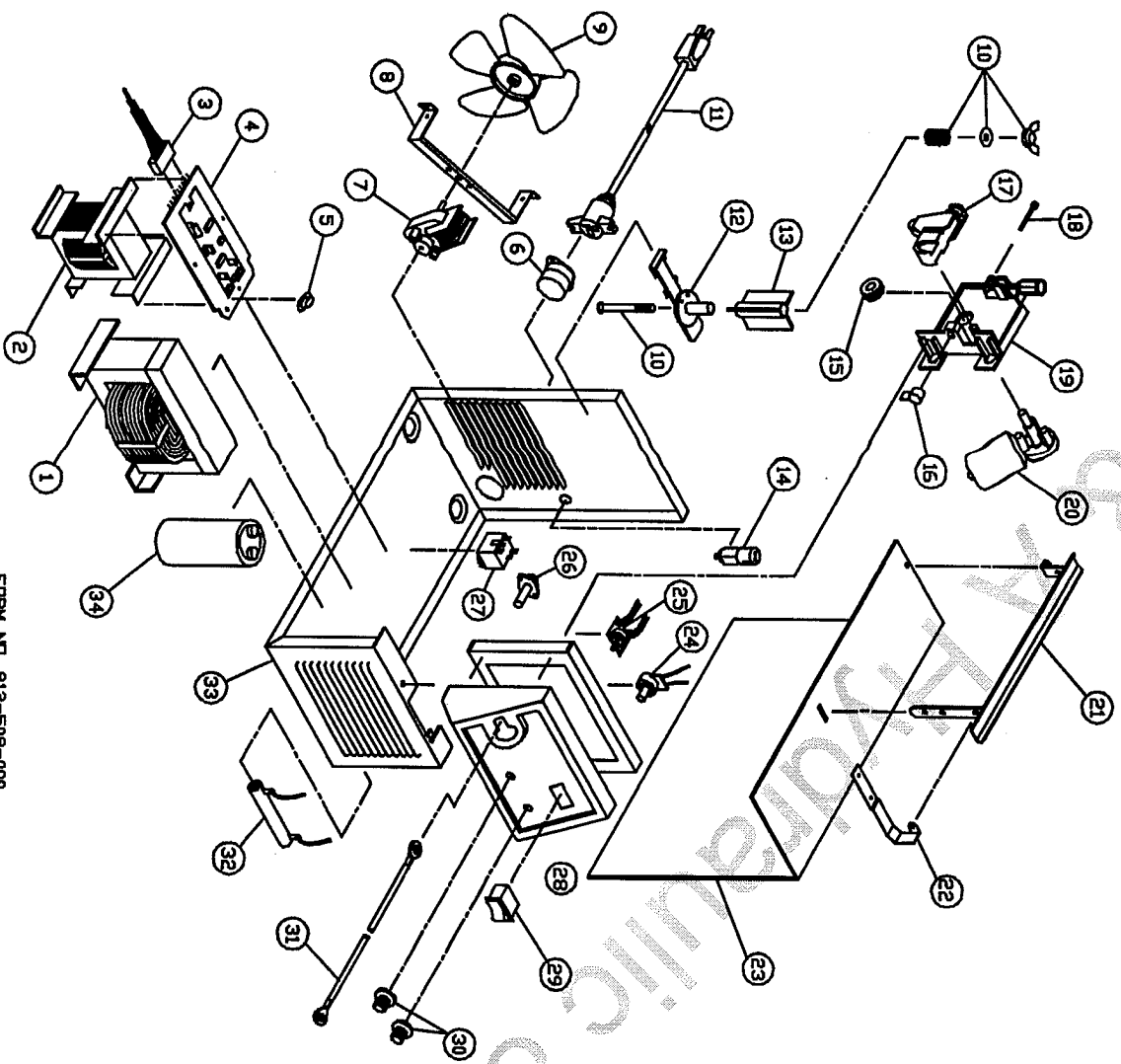

| ITEM | PART NO. | DESCRIPTION |
|------|-------------|---------------------------------|
| 1 | 880-188-888 | TRANSFORMER ASSEMBLY |
| 2 | 880-215-888 | REACTOR ASSEMBLY |
| 3 | 880-225-666 | WIRE HARNESS |
| 4 | 880-217-666 | HEATSINK/CIRCUIT BOARD ASSEMBLY |
| 5 | 216-053-666 | THERMAL PROTECTOR |
| 6 | 239-159-666 | POWER RECEPTACLE |
| 7 | 216-087-666 | FAN MOTOR |
| 8 | 412-375-000 | FAN MOTOR BRACKET |
| 9 | 316-009-666 | FAN BLADE |
| 10 | 131-213-000 | DRIVE TENSION HARDWARE |
| 11 | 248-226-666 | POWER CORD FOR 90 AMP OUTPUT |
| 12 | 4040 | POWER CORD FOR 105 AMP OUTPUT |
| 13 | 312-076-666 | WIRE SPINDLE |
| 14 | 312-077-666 | SPINDLE ADAPTOR |
| 15 | 246-212-666 | SOLENOID SWITCH |
| 16 | 310-154-666 | DRIVE ROLLER -045 SERATED |
| 17 | 4323 | DRIVE ROLLER .024/.030/.035 |
| 18 | 412-280-666 | COPPER RING BRACKET |
| 19 | 880-111-666 | DRIVE TENSIONER ASSEMBLY |
| 20 | 239-123-666 | INLET GUIDE TUBE |
| 21 | 880-130-666 | DRIVE BASE ASSEMBLY |
| 22 | 880-012-010 | HANDLE ASSEMBLY |
| 23 | 412-278-010 | HOOD HINGE |
| 24 | 410-586-010 | RIGHT SIDE PANEL |
| 25 | 245-108-666 | HEAT POTENTIOMETER |
| 26 | 880-219-666 | WIRE SPEED PCB |
| 27 | 246-116-666 | FUSE HOLDER |
| 28 | 245-060-666 | FUSE DNL |
| 29 | 246-258-666 | RELAY |
| 30 | 743-270-666 | MIG NOISE V/LABEL |
| 31 | 246-259-666 | ROCKER SWITCH |
| 32 | 4100 | KNOB |
| 33 | 860-523-666 | GROUND CABLE ASSEMBLY |
| 34 | 410-639-010 | GROUND CLAMP (NOT SHOWN) |
| 35 | 213-035-666 | BLEEDER RESISTOR ASSEMBLY |
| 36 | 238-155-100 | MIG BASE |
| 37 | 334-285-666 | CAPACITOR |
| 38 | 410-575-010 | GUN ASSEMBLY 10' (NOT SHOWN) |
| 39 | 4213 | GAS REGULATOR (NOT SHOWN) |
| 40 | 412-271-010 | STANDARD HELMET (NOT SHOWN) |
| 41 | 412-273-010 | TANK TRAY (NOT SHOWN) |
| 42 | 412-251-010 | TANK BRACKET (NOT SHOWN) |
| 43 | 412-249-000 | TANK TRAY STRAPS (NOT SHOWN) |
| 44 | 410-557-030 | TANK CHAIN (NOT SHOWN) |
| 45 | | LEFT SIDE PANEL (NOT SHOWN) |

FORM NO. 812-509-000
 REV. B

SERVICING SHOULD BE PERFORMED BY QUALIFIED SERVICE PERSONNEL.