

REPLACEMENT PARTS LIST
 SNAP-ON 140 AMP WIRE FEED WELDER
 MODEL 117-059, YA219C

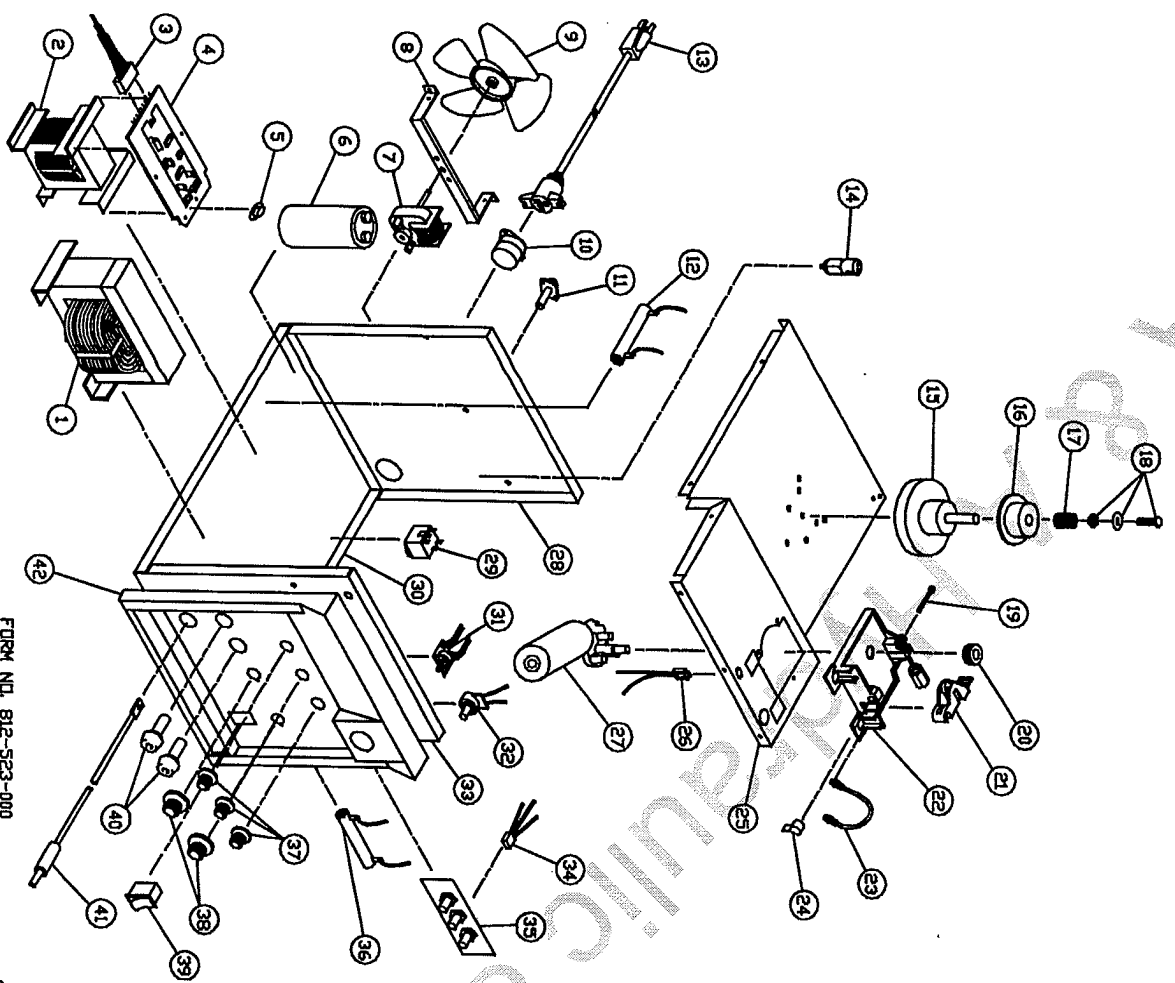

FORM NO. 812-523-000
 REV. B

SERVICING SHOULD BE PERFORMED BY QUALIFIED SERVICE PERSONNEL.
 Cart wheels (413-047-000), Axle (413-013-000)

ITEM	PART NO.	DESCRIPTION
1	890-188-898	TRANSFORMER ASSEMBLY
2	890-215-989	REACTOR ASSEMBLY
3	890-225-666	WIRE HARNESS
4	890-217-666	HEATSINK/CIRCUIT BOARD ASSEMBLY
5	216-053-666	THERMAL PROTECTOR
6	213-035-666	CAPACITOR
7	216-087-666	FAN MOTOR
8	411-072-666	FAN MOTOR BRACKET
9	316-009-666	FAN BLADE
10	239-159-666	RECEPTACLE ASSEMBLY
11	246-116-666	FUSE HOLDER
12	245-060-666	FUSE ONLY
13	860-523-666	BLEEDER RESISTOR ASSEMBLY
14	248-226-666	POWER CORD FOR LOW (90A) SETTING
15	4040	REQUIRES 20A BREAKER
16	246-212-666	POWER CORD FOR HIGH (110A) SETTING
17	312-066-666	SOLENOID SWITCH
18	312-110-666	MILDED SPINDLE
19	330-029-666	COMPRESSION SPRING
20	081-055-666	SCREW V/ WASHER AND NUT
21	239-123-666	INLET GUIDE TUBE
22	4347	DRIVE ROLLER .024/.030/.035
23	890-111-666	DRIVE ROLLER .045 SERATED
24	890-130-666	DRIVE TENSOR ASSEMBLY
25	412-290-666	DRIVE BASE V/NUT
26	410-651-010	POWER LEAD
27	890-227-666	CUMPER RING BRACKET
28	216-079-666	DRIVE MOTOR
29	410-650-010	WIRE HARNESS-GUN
30	246-259-666	BACK PANEL
31	410-648-666	RELAY
32	890-219-666	SPEED CONTROL PCB ASSEMBLY
33	245-108-666	POTENTIOMETER
34	410-654-010	FRONT PANEL
35	890-187-666	SPOT STITCH WIRE HARNESS
36	890-214-666	SPOT STITCH PCB ASSEMBLY
37	246-139-666	BRAKE RESISTOR ASSEMBLY 10A
38	246-140-666	CD KNOB 1 3/16" DIA
39	246-259-666	CD KNOB 1 1/2" DIA
40	312-046-666	ROCKER SWITCH
41	239-320-666	CD RECEPTACLE ASSEMBLY
42	312-139-666	CABLE ASSEMBLY
43	4108	NOISE WITH LABELS
44	410-326-110	GROUND CABLE ASS'Y 10' V/CLAMP NOT SHOWN
45	410-323-110	GROUND CLAMP NOT SHOWN
46	410-437-020	RIGHT SIDE PANEL NOT SHOWN
47	410-437-020	LEFT SIDE PANEL NOT SHOWN
48	246-103-666	HOOD NOT SHOWN
49	238-155-100	HANDLE ASSEMBLY NOT SHOWN
50	334-285-666	GUN ASSEMBLY 10' NOT SHOWN
		GAS REGULATOR NOT SHOWN