

REPLACEMENT PARTS LIST
100 AMP WIRE FEED WELDER
MODEL 117-061, 83100

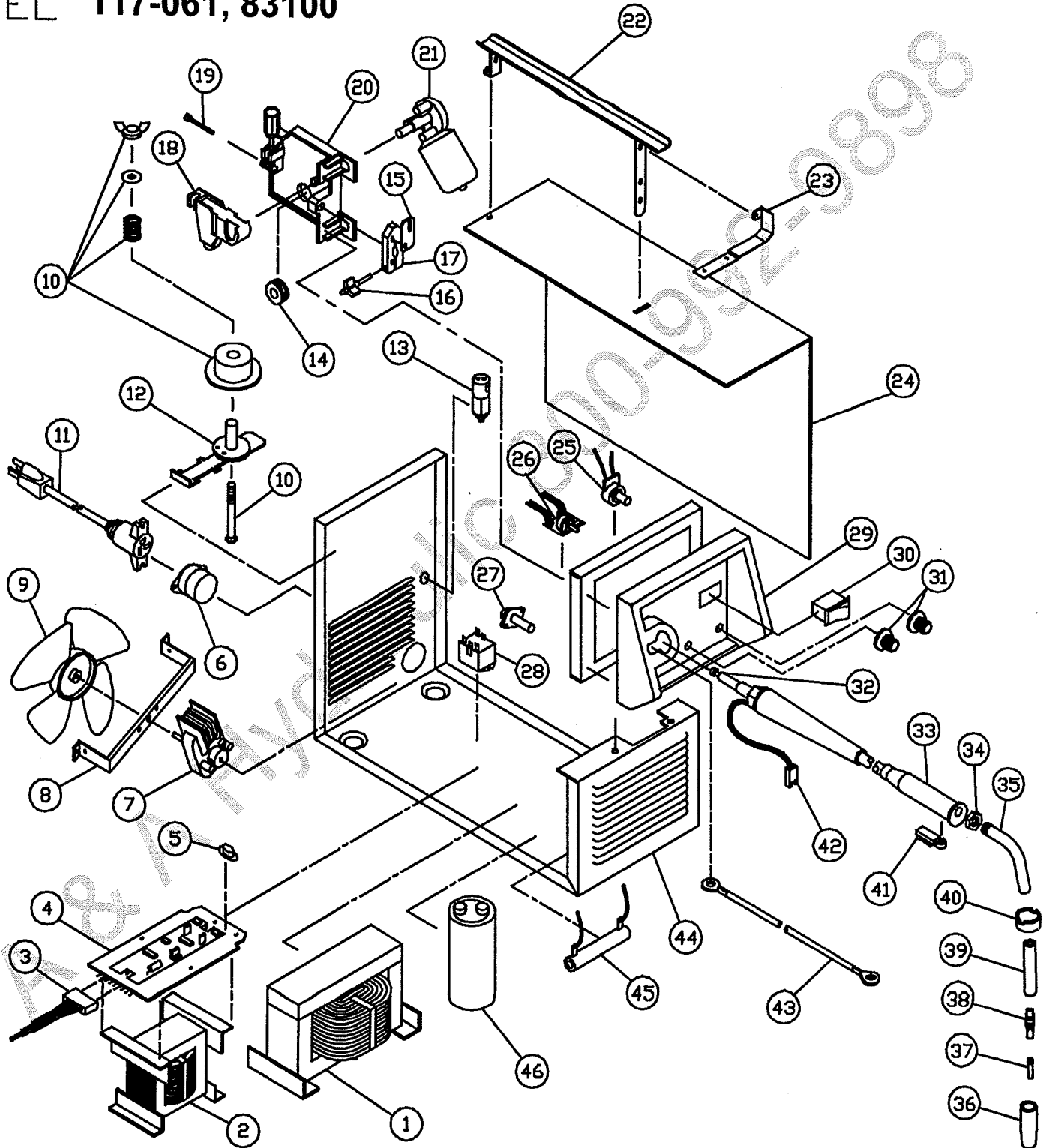

117-061 (83100), 100 Amp Mig

Item	Lincoln Stock #	Customer #	Description
1	Repair	880-188-888	Main weld transformer
2		880-215-888	Reactor Coil w/ thermostat
3		880-225-666	Wire harness
4	880-217-666	880-217-666	Circuit board
5	216-053-666	216-053-666	Thermostat
6		239-159-666	Power receptacle
7	216-087-666	216-087-666	Fan motor
8		412-375-000	Fan motor bracket
9		316-009-000	Fan blade
10	131-419-000	131-213-000	Tension hardware
11	S18475	248-227-100 (4040)	Power cord
12	312-076-666	312-076-666	Spindle
13	246-086-666	246-212-666	Gas solenoid
14	310-122-500	4323	Drive roller, 0.024 / 0.030 / 0.035
15		410-464-666	Copper jumper
16		246-326-000	Tension arm only
17	412-465-666	412-465-666	Mig Gun connector
18		880-111-666, 312-107-000	Tension arm only
19		239-123-666, 239-208-000	Inlet guide tube
20	880-130-666	880-130-666	Drive base with arm
21	216-089-666	216-089-666	Drive motor
22		880-012-010	Handle assembly
23		412-278-010	Hood hinge
24		410-568-020	Right side panel
25		245-108-666	Heat potentiometer
26	880-219-666	880-219-666	Wire speed pcb
27		246-116-666	Fuse holder cap
		245-060-666	Fuse only, BAN30 or BLN30

Model	Primary Input	Input Plug	Duty Cycle at Rated Output
117-061	120V, 20 amp	15A	20%

Item	Lincoln Stock #	Customer #	Description
28	246-258-666	246-258-666	Relay, 24Vdc coil
29		743-267-666	Mig nose w/label
30	246-259-666	246-259-666	90 / 110 Amp Rocker Switch
31	246-041-666	246-041-666	Knob
32	KP1937-1	4331	Steel liner
	KP1959-1	4325	Teflon liner
33	238-155-000	238-155-000	10' Mig Gun
34		334-220-000	Nut
35	334-227-000	334-227-000	Conductor tube
36	334-203-300	43480	Standard Nozzle
	334-203-400	M15578	Standard Nozzle
	334-211-300	43290, M15577	Spot Nozzle, Notched
37	334-159-300	43090	0.024 Contact Tips (6)
	334-160-300	43100	0.030 Contact Tips (6)
	334-161-300	43110	0.035 Contact Tips (6)
38	334-228-000	334-228-000	Gas diffuser
39	Included with #35	334-217-000	Conductor tube insulation
40		334-219-000	Handle cap
41	334-221-000	334-221-000	Trigger
42		860-744-000	Trigger harness
43		238-216-666	Ground cable only
44		410-639-010	Mig base
45		860-523-666	Bleeder resistor
46	S13490-109	213-035-666	Capacitor
Not Shown			
47	334-303-001	334-286-666	Gas regulator
48	059-245-666		Gas hose

Rated Output	Voltage Settings	Agency Listing	Max Output
90 amps	Infinite	CSA	100 amps