

# REPLACEMENT PARTS LIST

## MODEL 117-073

### 80 AMP DC MIG WELDER

117-073,2172,WFW80T

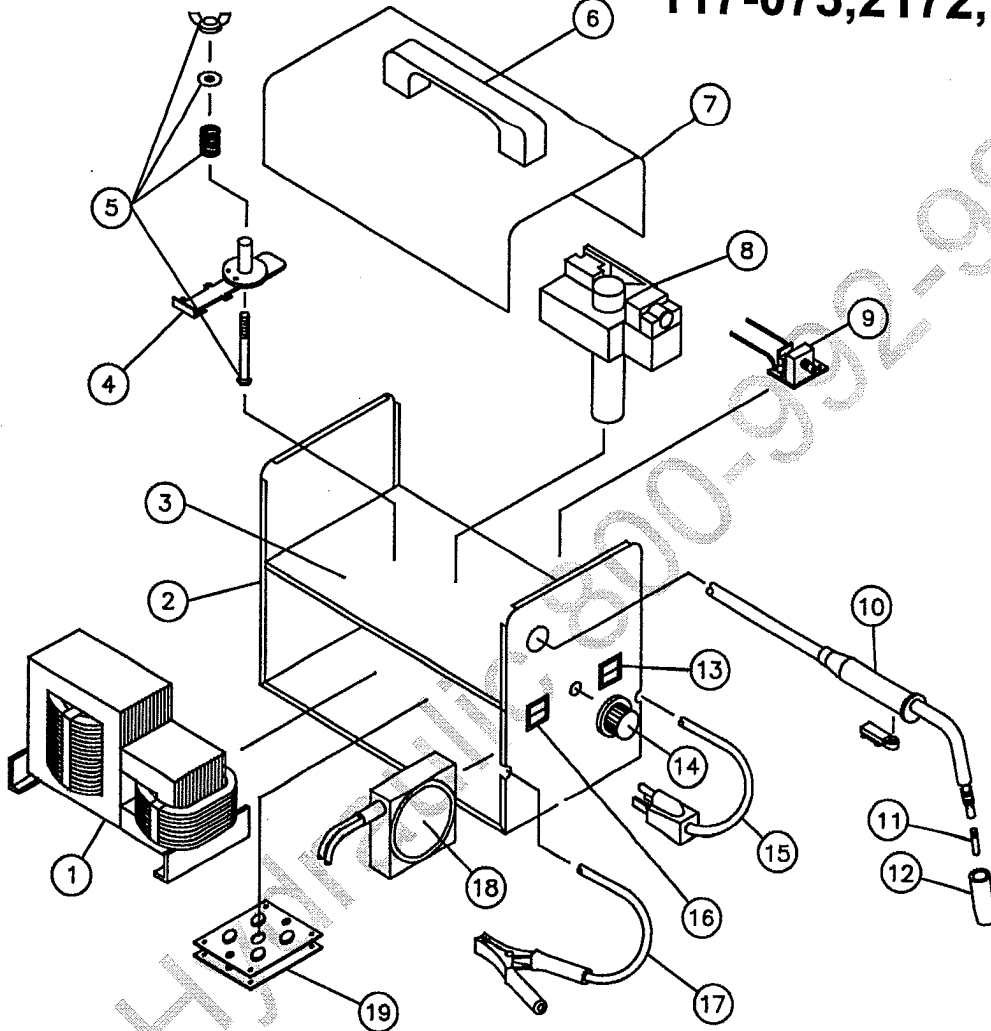

ITEM	DESCRIPTION	PART NUMBER	ITEM	DESCRIPTION	PART NUMBER
1	TRANSFORMER	880-400-888	11	CONTACT TIP	43090
2	BASE (BLACK)	410-853-010	12	NOZZLE	43480
	(RED)	410-853-020	13	SWITCH	246-405-666
3	SHELF	410-854-010	14	WIRE SPEED KNOB	246-107-666
4	SPINDLE	312-076-000	15	POWER CORD	248-322-666
5	SPINDLE TENSION KIT	131-350-001	16	SWITCH	246-404-666
6	HANDLE	312-264-666	17	WORK CLAMP ASSY	880-395-666
7	COVER (BLACK)	410-835-010	18	FAN MOTOR	216-098-666
	(RED)	410-835-020	19	RECTIFIER	880-402-666
8	DRIVE MOTOR ASSY	880-406-666	20	SIDE PANELS, BLACK (NOT SHOWN)	410-834-010
9	WIRE SPEED PCB	880-404-666		SIDE PANELS, RED (NOT SHOWN)	410-834-020
10	GUN ASSEMBLY	238-567-666			

**SERVICING SHOULD BE PERFORMED BY QUALIFIED SERVICE PERSONNEL.**

PART NO. 812-652-000  
REV. B