

118-017, YA3230

REPLACEMENT PARTS LIST
 SNAP-ON 100A 230V PLASMA ARC CUTTER
 MODEL YA3230 (118-017)

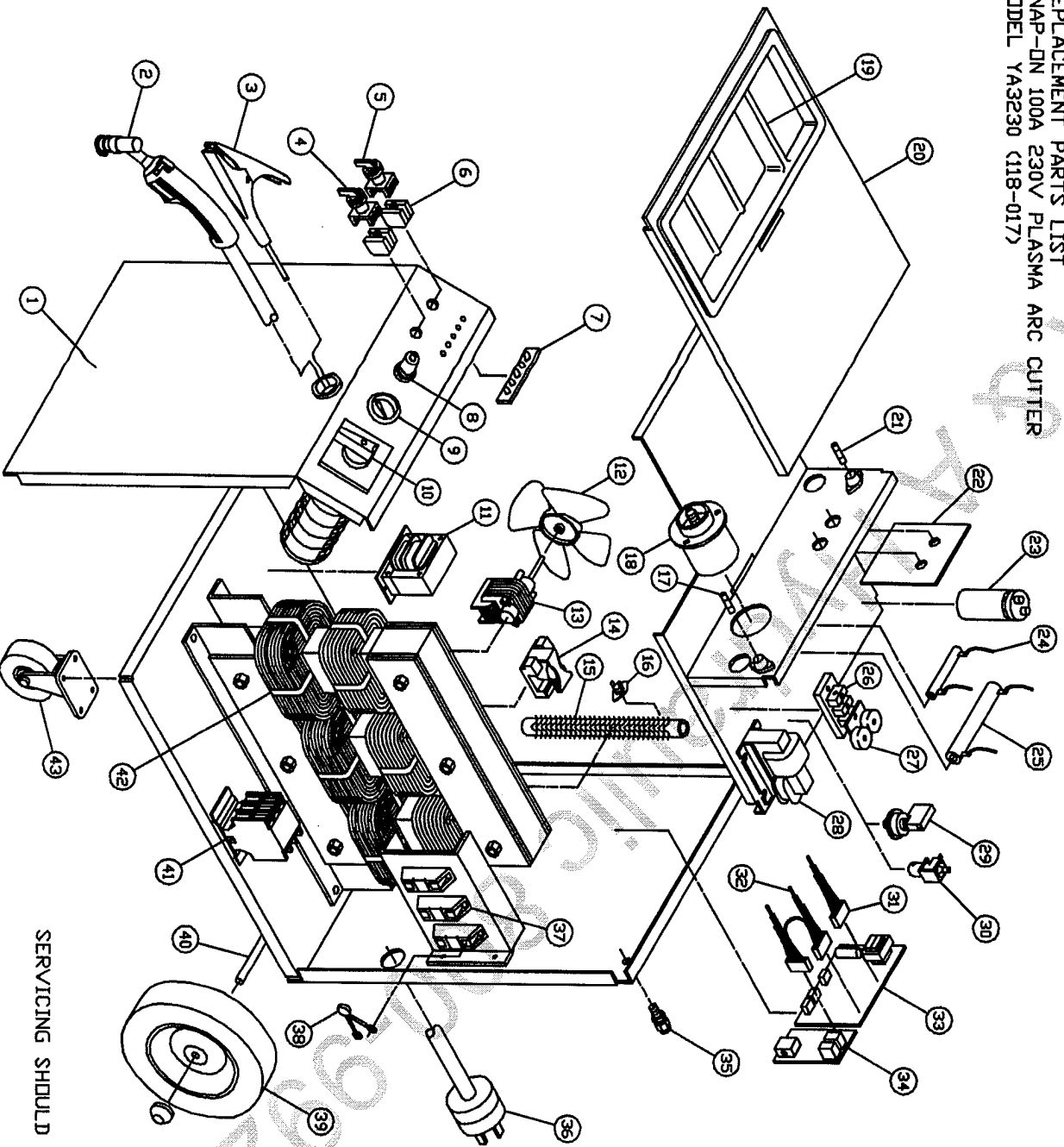

ITEM	DESCRIPTION	PART NUMBER
1	FRONT PANEL	743-209-666
2	HAND HELD TORCH ASSEMBLY, 25 FT	238-304-000 /
3	HAND HELD TORCH ASSEMBLY, 45 FT	238-304-000 /
4	MACHINE TORCH ASSEMBLY	238-304-000 /
5	(SEE FORM NO. 812-494-000 FOR	334-315-100
6	INDIVIDUAL TORCH PARTS)	
7	GROUND CABLE WITH CLAMP	238-305-666
8	CLAMP ONLY	239-010-102
9	RUN/SETUP SWITCH	246-231-666
10	PIVOT SWITCH	246-231-666
11	CONTACT GND	246-232-666
12	SIGNAL V CIRCUIT BOARD	246-233-666
13	AIR REGULATOR	880-200-666
14	PRESSURE GAUGE	254-005-666
15	RATE SELECTOR SWITCH V/KNOB	251-003-666
16	KNOB ONLY	246-246-666
17	CONTROL TRANSFORMER	246-246-666
18	FAN BLADE	880-199-888
19	FAN MOTOR	316-007-666
20	PILOT ARC RELAY	216-088-666
21	PILOT ARC RESISTOR	246-235-666
22	THERMAL BREAKER	245-100-666
23	5 AMP FUSE	216-073-666
24	COUPLING COIL	245-120-666
25	PARTS TRAY	880-205-666
26	4 AMP FUSES (GKG DF 3)	312-130-666
27	INPUT/OUTPUT CIRCUIT BOARD	743-219-666
28	CAPACITOR	243-116-666
29	5 OHM RESISTOR	880-206-666
30	500 OHM RESISTOR	213-028-666
31	SPARK BLOCK WITH POINTS	860-853-666
32	PILOT CAPACITORS	512-101-666
33	HI-VOLTAGE TRANSFORMER	213-029-666
34	AIR SAFETY SWITCH	880-202-666
35	AIR SOLENOID	246-234-666
36	WIRE HARNESS	245-166-666
37	MAIN CIRCUIT BOARD	880-198-666
38	PILOT ARC CIRCUIT BOARD	880-199-666
39	PORT FITTING WITH NUT	860-962-666
40	RECTIFIER	880-209-666
41	TRANSIENT PROTECTOR	253-089-666
42	WHEEL WITH HARDWARE	248-221-666
43	AXLE WITH HARDWARE	244-085-666
44	MAIN TRANSFORMER	880-077-666
45	CONTRACTOR	413-052-666
46	CUTTER MUST BE RETURNED FOR SERVICE)	413-054-666
47	CASTORS (2) WITH HARDWARE	410-632-016
48	RIGHT SIDE PANEL (NOT SHOWN)	410-633-016
	LEFT SIDE PANEL (NOT SHOWN)	412-357-666
	HANDLE (NOT SHOWN)	412-357-666
	CABLE WRAPS (NOT SHOWN)	412-359-016
	LIFTING RING (NOT SHOWN)	412-360-016

SERVICING SHOULD BE PERFORMED BY QUALIFIED SERVICE PERSONNEL.