

118-024, M12156

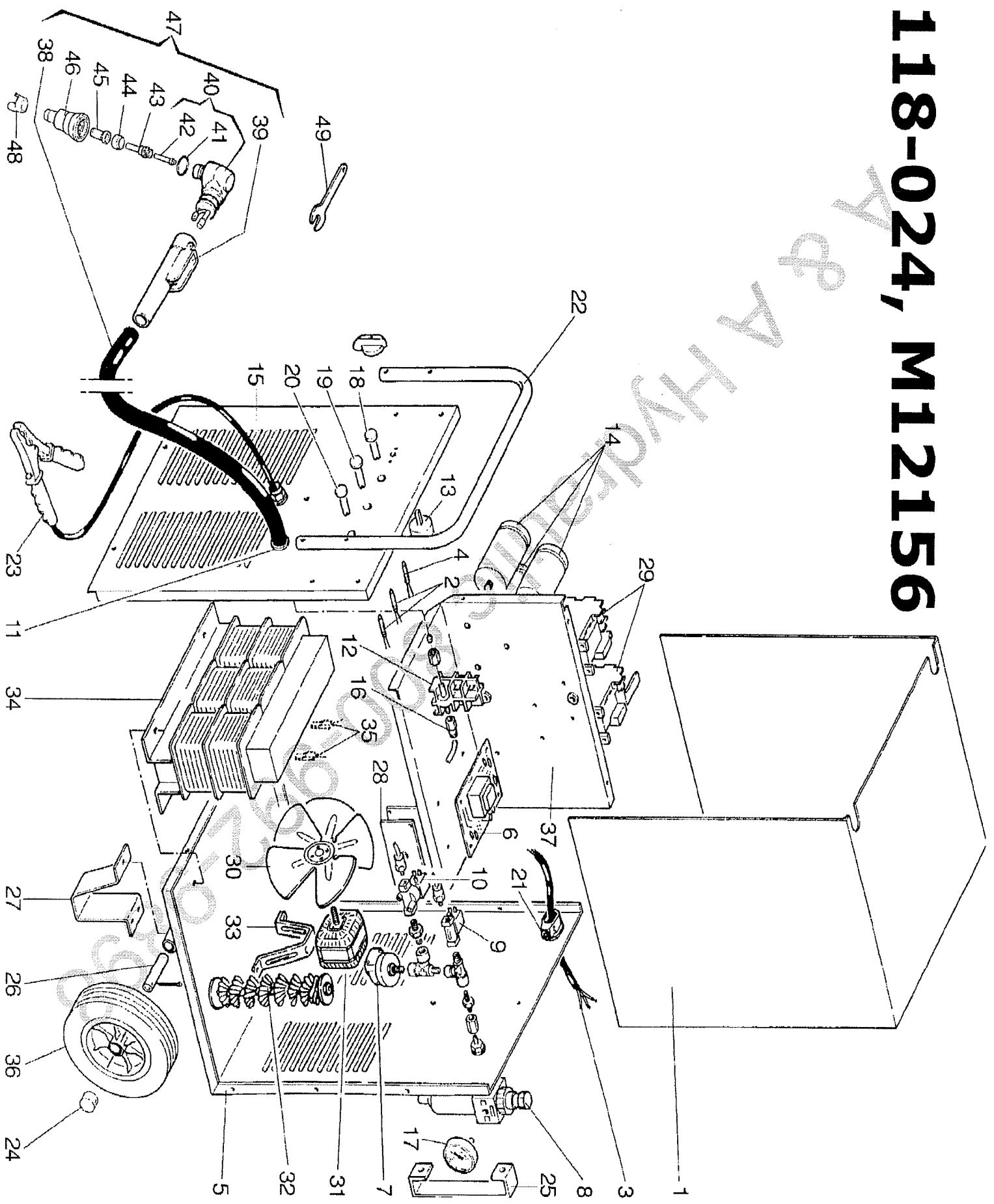

118-024, M12156 35 Amp Plasma Cutter

Item	Lincoln Stock #	Customer #	Description
1	238-712-666	B7000380	Housing
2	215-035-666	5585773	Lamp
3	238-713-666	260472	Input Cable
4	215-033-666	5585775	Lamp
5	411-117-016	260565	Bottom
6	860-997-666	5602146	Control Circuit Board
7	246-532-666	B7005380	Pressure Switch
8	254-006-666	B7006380	Air Regulator
9	246-516-666	B7007380	Solenoid Valve
10	246-525-666	3160196	Solenoid Valve
11	334-607-666	B7016380	Cable Bushing
12	239-298-666	B7009380	Terminal Board
13	246-527-666	261543	Power Switch
14	213-043-666	260468	Condenser
15			Front Panel
16	253-340-666	B7013380	Coupling
17	251-030-666	B7014380	Gauge
18	245-168-666	266250, 245-172-666	Lamp Holder
19	245-170-666	B7015380	Lamp Holder
20	245-169-666	246251	Lamp Holder
21	414-020-666	B7018380	Strain Relief
22	312-523-666	B7019380	Handle
23	238-709-666	B7020380	Earth/Ground Cable Assy
24	411-107-026	250224	Cover
25	215-031-666	250901	Protection

Model	Primary Input	Input Plug	Duty Cycle at Rated Output
118-024	230 Vac	None, draws 21 amps	25%

Item	Lincoln Stock #	Customer #	Description
26	413-115-666	B7034380	Axle
27	412-756-666	B7035380	Foot
28	244-089-666	261546	Rectifier
29	246-518-666	B7026380	Contact
30	216-113-666	B7027380	Fan Blade
31	216-108-666	246224	Fan Motor
32	215-030-666	251190	Resistor
33	412-752-666	246188	Support
34	880-583-666	261547	Transformer
35	246-531-666	251156	Thermostat
36	413-118-666	B7033380	Wheel
37	412-751-666	261549	Intermediate Panel
38	238-706-666	5580779	Torch Cable
39	312-518-666	B7037380	Handgrip w/push button
40	334-588-666	1346	Torch Head
41	512-264-666	251194	O-Ring
42	334-587-666	3065225	Diffuser
43	334-580-100	--	Electrode
44	334-583-100	--	Swirl Ring
45	334-581-100	--	Nozzle 0.9 mm
46	334-584-100	--	Nozzle Holder
47	238-696-666	1212.18	Complete Torch Assy
48	334-585-100	--	Two-Point Spacer - Standoff
49	334-604-000	5800818	Electrode Wrench

Rated Output	Voltage Settings	Agency Listing	Max Cutting Thickness
35 amps	1	CSA	3/16"