

M112104 02-210 ABD:257 (Rev. 4-67)

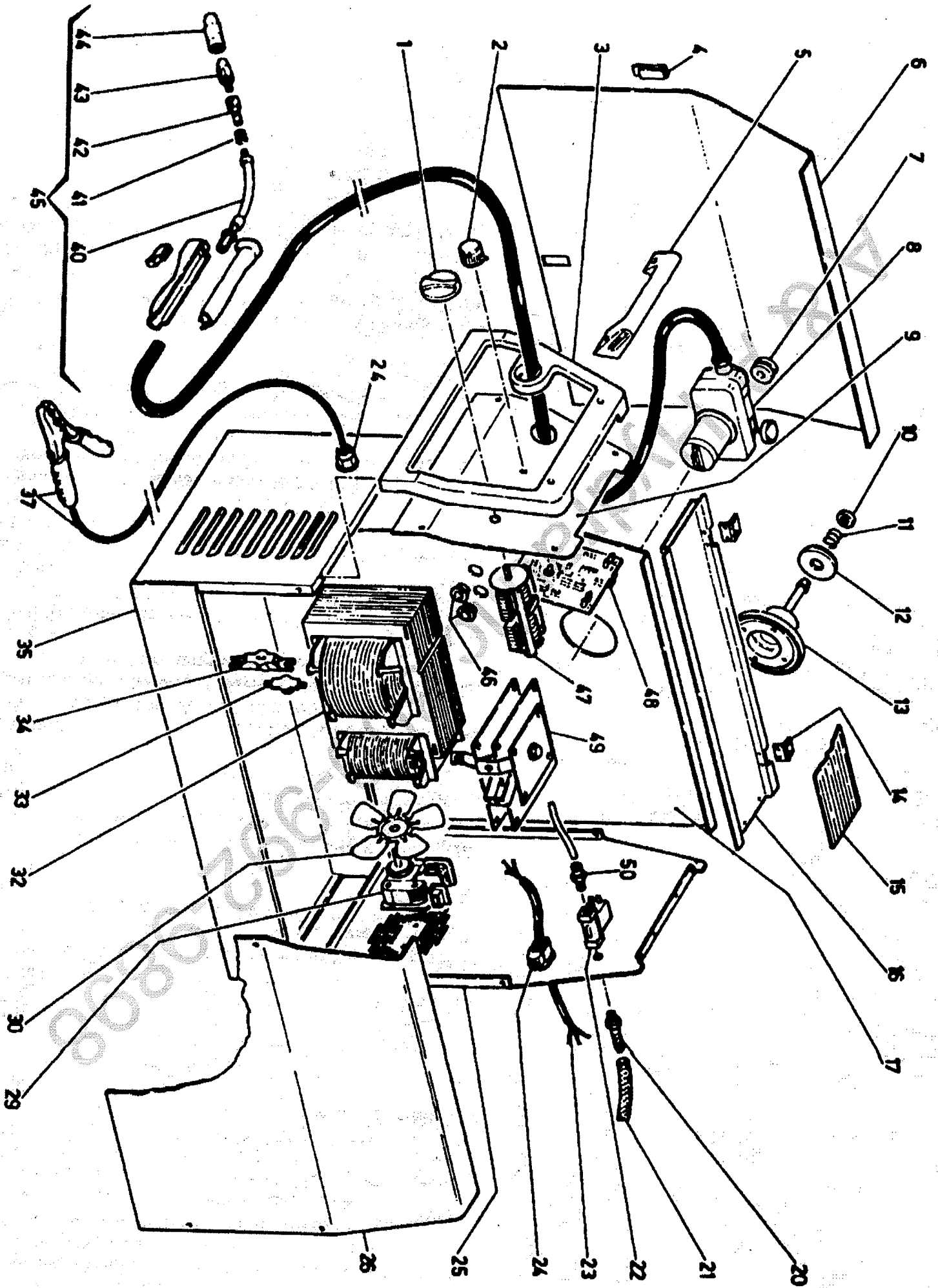

M12184, MB135, 83-318

Item	Stock #	Customer #	Description
1		246945	Knob
2		246946	Knob
3		246947	Frame
4		246948	Latch
5		246949	Handle
6		246950	Hinged Side Panel
7	310-210-666	246951	Drive Roller
8	216-116-000	246952	Wire Feed Motor
9		251049, 251050	Control Panel
10		251030	Ring
11		251031	Spring
12		251027	Coil Support Spacer
13		251022	Coil Support
14		246958	Hinged Side Panel
15		246959	Rubber Mat
16		246961	Cover
17		246962	Center Divider
20			Hose Barb Joint
21	059-245-666	246169	Gas Hose
22	246-530-666	251036	Solenoid Valve
23		B7023370	Power Cord
24		B7022370	Strain Relief
25		246971	Back Panel
26		246972	Fixed Side Panel
29		251037	Fan Motor

Model	Primary Input	Input Plug	Duty Cycle at Rated Output
M12184	120V, 23 amp	15A	15%

Item	Stock #	Customer #	Description
30		246193	Fan Blade
32		251044	Transformer
33	S26399-21	B7065370	Thermostat
34	S26399-20	B7028370	Thermostat Support
35		251048, 251020	Undercarriage
37	S26399-3	246983	Ground Cable
40	334-628-000	B7123370	Gooseneck
41	334-172-000	B7124370	Spring
42	334-632-000	246311	Diffuser
43			Contact Tip
	KP2039-1B1	M15522	0.024 Contact Tips
	KP2039-2B1	M15523	0.030 Contact Tips
	KP2039-3B1	M15524	0.035 Contact Tips
44	334-164-400	M15520	Nozzle
45	334-634-000	247008	Torch Assembly
46		246993	Cable Outlet
47		246994	Switch
48	880-595-000	251045	Circuit Board
49	S26399-5	246996	Rectifier
50		246997	Fitting

Not Shown			
51	334-637-000	246199	Steel Liner
52	334-645-000	M15520	Teflon Liner
53	334-286-666		Gas Regulator

This Unit had a 1 Year Warranty (90 days on the Gun)

2/28/2006

Rated Output	Voltage Settings	Agency Listing	Max Output
90 amps	7	CSA	135 amps